

Clinical Trials

At Grampians Health Ballarat

We have

- over 50 years of combined study coordinator experience, with a team of:
 - over 20 principal investigators
 - 8 study coordinators
 - clinical trials manager and clinical trials assistant
- research staff who are well trained and ICH-GCP and IATA certified
- electronic management of essential clinical trial documents, complying with ICH-GCP, including:
 - electronic medical record system (BOSSnet, ARIA and Sponsor based)
 - SiteDocs (for maintaining electronic ISF)
 - Ethical review manager (ERM)
 - TrialMATE (BHS internal essential trial document filing system)
 - documented Standard Operating Procedures (SOPs)

Governance

Our efficient and experienced research governance office is committed to supporting research. The team processes site-specific assessments across research domains. Our team's approval time is around two to three weeks after lead site approval.

Facilities and services

- dedicated patient assessment and central processing facilities
- Pharmacokinetic (PK), Pharmacodynamics (PD) and Pharmacogenomics (PGx) testing
- on-site clinical trials pharmacy with secure, controlled access and storage of IP
- on-site pathology with phlebotomy, processing, reporting services; archival, and fresh tissue preparation
- diagnostic services

Alongside clinical trials, Grampians Health also offers:

- on-site Dorevitch Pathology
- Ballarat Austin Radiation Oncology Centre (BAROC)
- imaging (X-ray, CT, MRI and nuclear medicine; PET with Lake Imaging in some locations)
- ophthalmology
- Intensive Care Unit
- Emergency Department
- Allied Health

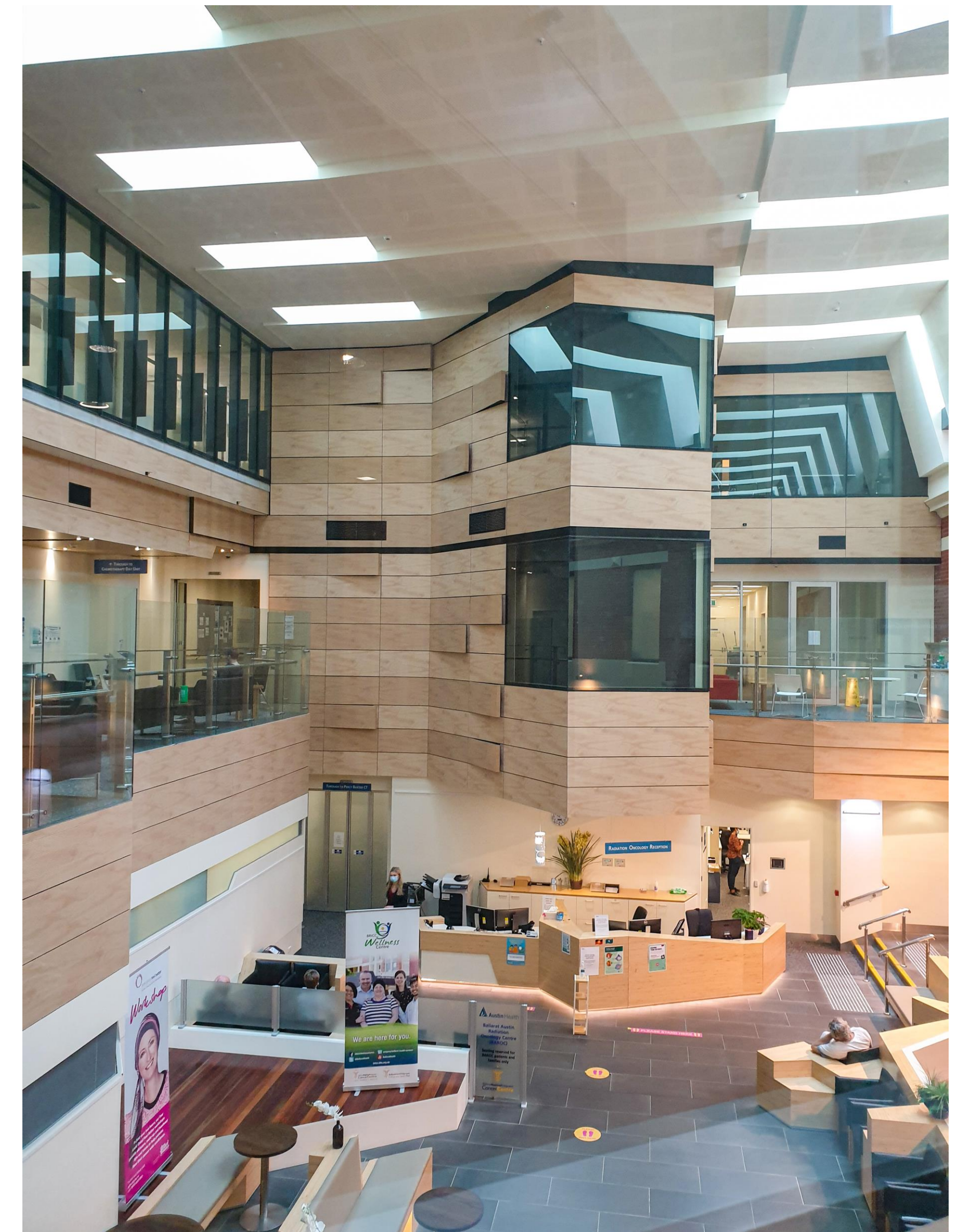

BRICC Building

Contact us

Carmel Goss

Clinical Trials Manager

Carmel.Goss@bhs.org.au

03 5320 4735

Clinical Trials department

Level 2, Ballarat Regional

Integrated

Cancer Centre (BRICC)

Ballarat Health Services

1 Drummond Street North

Ballarat, VIC, 3350

Clinical Trials

At Grampians Health Ballarat

Our location

Established in 2021, Grampians Health brings together Ballarat Health Services, Wimmera Health Care Group, Stawell Regional Health and Edenhope and District Memorial Hospital.

Grampians Health Ballarat has the largest clinical trials unit in Western Victoria, and the health service is the primary referral hospital for the Grampians region – which stretches from Bacchus Marsh to the South Australian border.

The region covers around 48,000m² and is home to over 254,000 people or 17% of regional Victoria's population.



Grampians region in Victoria

Site capabilities

- trial capabilities – Phase IB, II, III, IV
- time from site selection to first patient in study is about four weeks
- local oncology service reviewing around 1,100 new medical oncology/haematology patients every year
- running over 100 clinical trials and recruited over 250 participants
- patient recruitment opportunities in allied health, anaesthetics, cardiology, endocrinology, gastroenterology, haematology, infectious diseases, intensive care, neurology, obstetrics and gynaecology, paediatrics, and surgery.



Private room for monitoring activities



Clinical research office

Find out more

For more information on clinical trials at Grampians Health, visit www.bhs.org.au/research